

Thank you for purchasing iPort's **"ServerCall"** Server Paging System. Your system has been pre-programmed at the factory and will function once mounted and plugged in.

Transmitter Set Up & Mounting Instructions:

- 1) Mount the transmitter unit onto the cook line using the included brackets, or remove the rear brackets and mount it directly to the wall if desired. The unit will mount using the 4 keyhole cutouts in the back panel. To mount to the wall, drill holes for the wall inserts included using the included template. To stand unit up remove the small bracket, flip over the large bracket and tighten at desired location. Wall mount template provided on page 11.
- 2) Plug the 2-amp wall transformer into any suitable AC outlet. Plug the power connector into the power jack on the bottom right hand side of the unit. (Surge protector recommended!)
- 3) Mount the transmitter in a convenient location away from heat lamps, steam tables and water.

EQUIPMENT SET UP

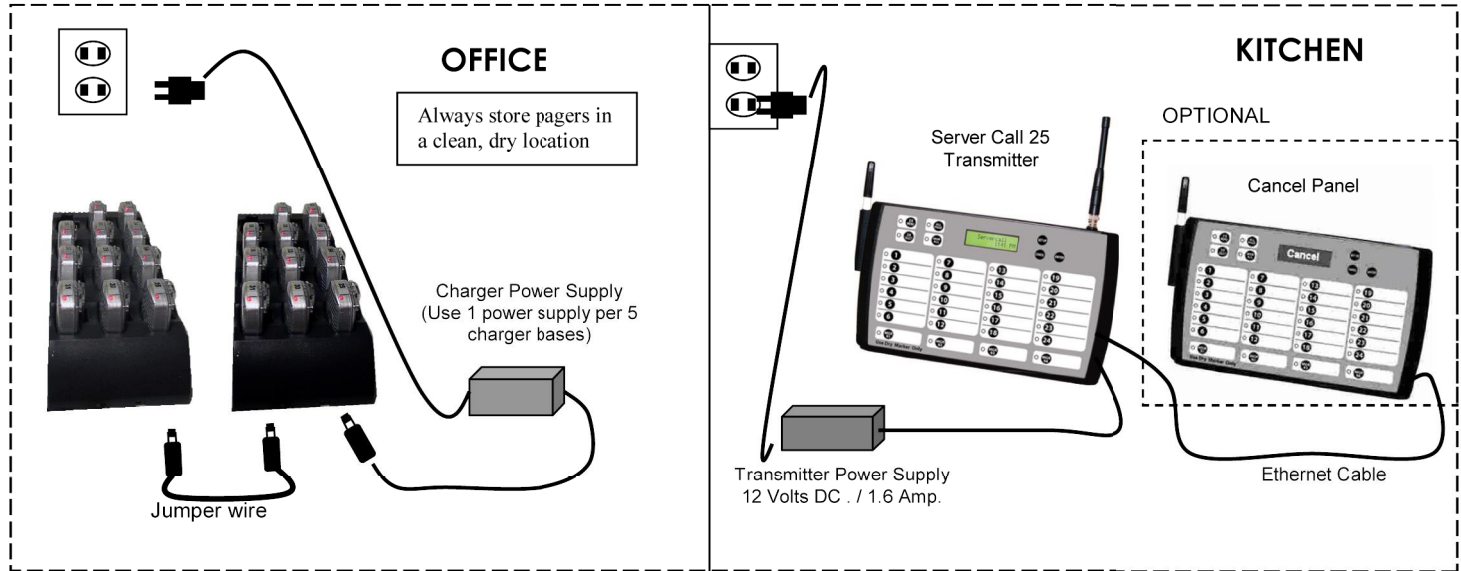

TRANSMITTER SET UP & MOUNTING INSTRUCTION

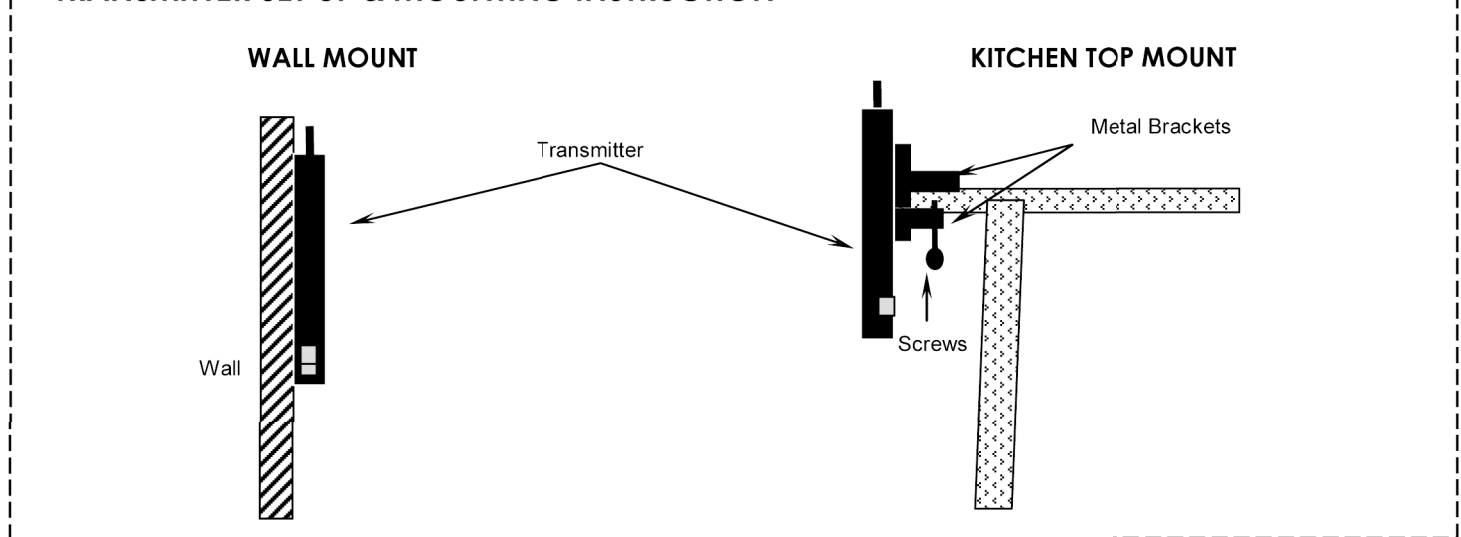

TRANSMITTER BRACKET INSTALLATION